



MasterColor CDM-TM

CDM20/TM/830 12PK

Introducing the smallest 20W ceramic metal halide lamp together with the unique e-Vision® electronic ballast. It's visually pleasing and financially rewarding, so the focus can be on your merchandise and not the ceiling clutter.

Product data

General Information	
Base	PGJ5 [PGJ5]
Operating Position	Universal [Universal]
Life to 5% Failures (Nom)	9000 h
Life To 10% Failures (Nom)	10000 h
Life to 20% Failures (Nom)	11000 h
Life to 50% Failures (Nom)	12000 h
Light Technical	
Color Code	830 [CCT of 3000K]
Luminous Flux (Rated) (Nom)	1600 lm
Color Designation	Warm White (WW)
Lumen Maintenance 1000 h (Nom)	80 %
Lumen Maintenance 10000 h (Nom)	60 %
Lumen Maintenance 2000 h (Nom)	75 %
Lumen Maintenance 5000 h (Nom)	65 %
Chromaticity Coordinate X (Nom)	0.433
Chromaticity Coordinate Y (Nom)	0.392
Correlated Color Temperature (Nom)	3000 K
Luminous Efficacy (rated) (Nom)	72 lm/W
Color Rendering Index (Min)	84
Color Rendering Index (Nom)	87

Operating and Electrical	
Power (Rated) (Nom)	22.1 W
Lamp Current Run-Up (Max)	.5 A
Re-Ignition Time (Min) (Max)	15 min
Ignition Time (Max)	30 s
Voltage (Max)	108 V
Voltage (Min)	95 V
Voltage (Nom)	100 V
Controls and Dimming	
Dimmable	No
Run-Up Time 90% (Max)	3 min
Mechanical and Housing	
Bulb Finish	Clear
Approval and Application	
Energy Efficiency Label (EEL)	A
Mercury (Hg) Content (Nom)	2.4 mg
Energy Consumption kWh/1000 h	24 kWh
UV	
Pet (Niosh) (Min)	8 h/500lx

MasterColor CDM-TM

Damage Factor D/fc (Max)	0.5
Luminaire Design Requirements	
Bulb Temperature (Max)	380 °C
Cap-Base Temperature (Max)	250 °C
Product Data	
Order product name	CDM20/TM/830 12PK
EAN/UPC - Product	046677140403

Order code	140400
Numerator - Quantity Per Pack	1
Numerator - Packs per outer box	12
Material Nr. (12NC)	928087905115
Net Weight (Piece)	0.005 kg
ILCOS Code	MT/UB-20/830-H/L-PGJ5-13.3/52

Dimensional drawing

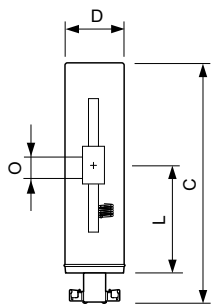

CDM-Tm 20W/830 PGJ5

Product	D (max)	D	O	L (min)	L (max)	L	C (max)
CDM20/TM/830	13.2 mm	0.44 in	3 mm	22.3 mm	22.9 mm	22.6 mm	52 mm
12PK							

Photometric data

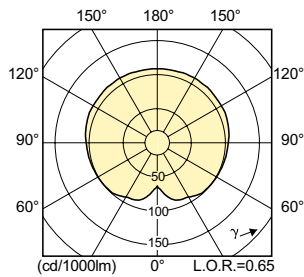
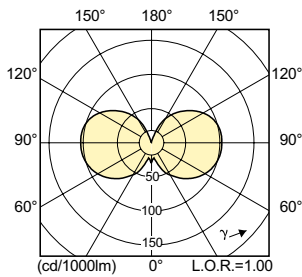

MasterColor CDM-TM

Lifetime

