

# LED HIGH EFFICIENCY, EXPANSIVE CAVITY RECESSED (ASC)

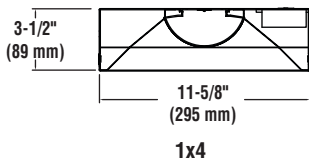
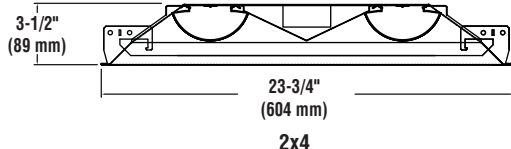

LIGHT OUTPUT - ASC								
Description	SS - Super Saver			HO - High Output			Watts	
	WW	NW	CW	WW	NW	CW	SS	HO
2 x 2	2480	2580	3030	2930	3035	3600	30	37
2 x 4	3990	4440	4805	4890	5400	5910	45	54
1 x 4	2490	2530	2980	2965	3010	3530	30	37

## PRODUCT HIGHLIGHTS

- Specifically designed to spread uniform illumination throughout the room cavity from ceiling to floor.
- Long life, high brightness LEDs virtually eliminate maintenance.
- RoHS compliant, recyclable design has no mercury or other hazardous materials
- Cooler running electronic components allow for improved lumen performance.

**EXPECTED LIFE** - Projected life of at least 60,000 hours. Contact factory for TM-21 detail.

**LEDs** - Use of closely-spaced medium-power, high-brightness chips minimizes pixelation and provides uniform lens luminance. Available in Cool White (5300°K), Neutral White (4100°K) and Warm White (3500°K) color temperatures. CRI >= 80. LM-80 reports available.

**HOUSING** - Formed code-gauge steel housing, painted after fabrication. Integral NEC-compliant earthquake clips are standard.

**LENS** - Specially designed frosted extruded acrylic lens with micro prisms for maximum source diffusion and soft, even illumination.

**INSTALLATION** - Unit simply lifts through grid ceiling and rests on T-bars. Wiring access/strain relief plate attaches with one screw, allowing connections to be made from below the ceiling.

**ELECTRIAL**- Universal voltage (120-277 Vac) input, 50/60 Hz. Power factor > 0.9, THD < 20%, in-rush current < 15 Amps.

**DRIVER** - High-performance isolated driver features over-voltage, over-current and short-circuit (with auto-recovery) protection. Driver module is sealed to IP66 protection levels, with a Class A sound rating. 0-10 volt dimming standard.

**OPERATING TEMPERATURE** - -40°C to +40°C (-40°F to +104°F)

**FINISH** - All metal parts painted after fabrication following treatment with phosphate rust inhibitor. Finish coating of housing reflecting surfaces is with high-reflectance (minimum 92%) polyester powder. Matte white reflectors for soft indirect light distribution.

**WARRANTY** - Limited 5-year warranty.

**PHOTOMETRICS** - Please visit our web site at [www.lsi-industries.com](http://www.lsi-industries.com) for detailed photometric data.

**LISTING** - Listed to UL1598 and other U.S. and Canadian safety standards.



## LUMINAIRE ORDERING INFORMATION

TYPICAL ORDER EXAMPLE: **ASC22 LED SS NW UE**

Prefix	Shield	Light Source	Drive Current	Color Temperature	Input Voltage	Options
ASC22 - (2X2)	(blank) - Acrylic	LED	SS - Super Saver HO - High Output	CW - Cool White NW - Neutral White WW - Warm White	UE - Universal Input Voltage (120-277V)	EM - 1100 Lm Emergency FC-1 - 6"x3/8" (3) #18 leads CPL - Chicago Plenum
ASC24 - (2X4)						
ASC14 - (1X4)						

## ACCESSORY ORDERING INFORMATION (Accessories are field installed)

Description	Order Number
Flange Kit - 2x2	FK22
Flange Kit - 2x4	FK24
Flange Kit - 1x4	FK14